

FREEHOLD

Three Bedrooms

946 sqft

Glandwr

Panteg
Whitemill
Carmarthenshire
SA32 7HE

Offers in the region of

£315,000



A stone-built country cottage of character and warmth, blending period features with generous natural light and far-reaching rural views.



A charming three-bedroom detached cottage set amidst the rolling Carmarthenshire countryside, offering light-filled interiors, a pretty garden, and scope for refinement.







Glandwr is a delightful detached cottage, extending to 946sqft, nestled in the tranquil heart of the Carmarthenshire countryside.



Surrounded by rolling hills, wooded valleys, and ancient trees, the property enjoys a wonderfully private and rural setting whilst remaining accessible to the market town of Carmarthen.

The cottage sits within a charming garden, with the stone façade and traditional proportions creating an inviting first impression. Inside, the accommodation is compact yet well-planned, offering scope for further refinement.



The principal living space is an open-plan sitting and dining room, extending to almost 23ft, with windows to both front and rear aspects ensuring an abundance of natural light. At one end, the room connects to a well organised kitchen.



At the opposite side of the house, a bright conservatory overlooks the garden, providing a versatile further reception space.

On the first floor, there are three bedrooms together with a family bathroom. The bedrooms, particularly the principal, enjoy views across the surrounding countryside, underlining the sense of rural peace and seclusion that defines this cottage.

While not a finished product, Glandwr retains the charm of a traditional country home and offers an excellent opportunity for a purchaser to place their own mark upon it, whether as a full-time residence, country retreat, or holiday cottage.





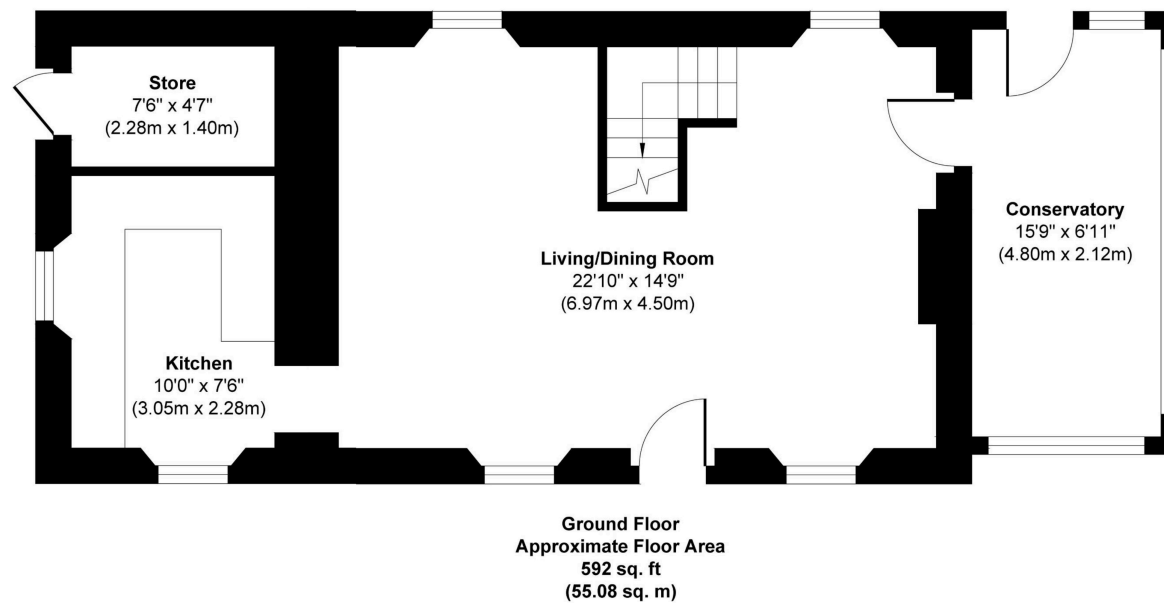
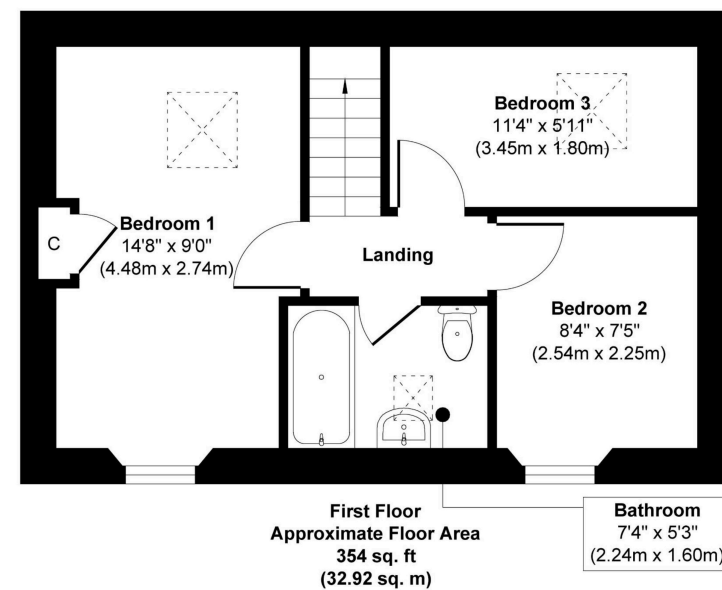
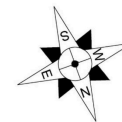

Approx. Gross Internal Floor Area 946 sq. ft / 88.00 sq. m

Illustration for identification purposes only, measurements are approximate, not to scale.

Produced by Elements Property

The property is FREEHOLD
The property benefits from a private water source, private
sewage system, and LPG gas for the central heating. It is
connected to mains electricity.
The Council tax is Band D (£2,232p.a.)



The Location

Panteg is a small and peaceful hamlet just 7 miles east of Carmarthen (approx. 15 minutes by car), where you will find a wide range of shopping, leisure, and cultural amenities. The town also provides excellent schooling, a university campus, and a mainline railway station with connections to Swansea and Cardiff.

The surrounding countryside is renowned for its beauty, with the River Towy winding through the valley and a host of woodland and riverside walks to explore directly from the village. Outdoor pursuits are easily accessible, with Brechfa Forest nearby offering walking, cycling, and riding routes, while the Carmarthenshire coast—including Llansteffan Beach and Pendine Sands—can be reached within half an hour.

For commuters, the A40 links directly to the A48 and M4, bringing Swansea within 40 minutes and Cardiff around 75 minutes. This balance of natural tranquillity and connectivity makes Whitemill an attractive and accessible rural setting.





Glandwr, Panteg

THE
GREENROOM
ESTATE AGENCY



Address

28-30 Dunns Lane
Mumbles
SA3 4AA



Phone

01792 986099



E-mail and Web

www.thegreenroomhomes.com
info@thegreenroomhomes.com